

DRAGON V30



UNSTOPPABLE

The Dragon V30, can travel on any terrain, sea level, any conditions of the sea, making it virtually unstoppable in terms of modern day transportation.

Up to 30 passengers can sit comfortably in the vehicle, cruising at 30 knots or more depending on customer 's requirements.

With its exceptional benefits, ferrying people in any sea conditions including rough seas of up to 2 metres, from shore to shore, regardless of low or high tide.

Test ride one today!

3 YEARS
WARRANTY
INCLUDED



REAL
MARINE



SPECIFICATIONS

Length	17.0 Metres
Width	7.0 Metres
Propeller	4.27 Metres
Engine	650 HP V8 Deutz Diesel Engine or High Performance 1,000 HP V12 Doosan Diesel Engine
Speed Cruise	30-35 knots. Maximum Speed 50 - 70 knots depending on engine horsepower.
Maximum Loading	3 tones or 30 passengers with luggage
Range	300 Nautical Miles. Reduce passenger load and replace with fuel range is much more.
Benefits	<ul style="list-style-type: none"> • Easy to operate • Engines have life span of up to 18,000 Hours • Able to travel on choppy waves of up to 2 metres • Fuel consumption is lower as compared to vessels with the same capacity • Larger capacity hovercraft can be built according to customer's preference

* Technical Specifications Are Subject To Change Due To Our Continuous Improvement Programme

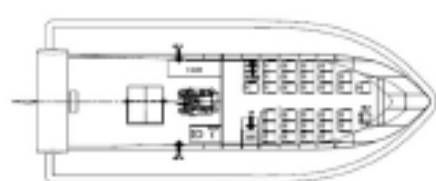

Plan view showing side decks for additional storage.

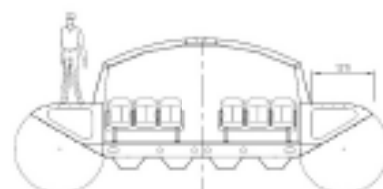

Cargo can be carried on the outside decks up to 12 metres in length. Storage room under the side decks access from cabin or external hatches if required by customer. Sound levels are so low passengers can travel on side decks at low speeds.

* Customisation is possible, please contact us for discussions

LONG ENGINE LIFESPAN OF UP TO 18,000 HOURS RUN WITHOUT FAIL IN CHOPPY WAVES UP TO FORCE 6 (2 METRES IN HEIGHT)

DETAILED BENEFITS



Wide Isle be customized for any requirements



2 metre ceiling height.
Complies to I.M.O
International Regulations



Silent 4.27 metre ducted seven blade, pitch in motion 700 RPM propeller.

WORLD FIRST TECHNOLOGY.

RELIABLE

Proven over tens of thousands of operating hours

EASY TO LEARN

Requires the same time to learn to operate as learning to drive a car.

MAINTENANCE MADE EASY

No Special skills are required, common diesel or boat mechanics can service and maintain the craft.

REQUIRE MINIMAL TRAINING

From one day for the smallest craft to eight weeks for the largest.

PRODUCES VERY LITTLE SPRAY

Low cushion pressures keeps spray to almost negligible.

NO WASH/WAKE

There is virtually no wash/wake at high speed.

NO BERTHING PROBLEMS

Will operate equally successfully at unprepared beaches and riverbanks as to piers, pontoons and harbours.

LOWER INITIAL COSTS

More economical prices as to conventional boats of the same size, speed and payload.

LOWER OPERATING COSTS

Comparable operating costs to conventional boats of the same size, speed and payload.

DIESEL ENGINES

Give reliability, long life and economy.

NEGLIGIBLE NOISE LEVELS

Comparable to trucks or high speed boats.

DURABLE

Dragon V30 aluminium hulls offer a greater protection from impact, an improved fire resistance, a longer life span as well as ease of repair compared.

FULLY AMPHIBIOUS

Operate over water, land, sandbanks, mudflats, weed, ice, rocks and rapids and rough seas.





Real Offshore Installation Company

Marine Division

Tel : +614 03 282440 / +614 1099 2838

Email : admin.marine@realoffshore.com.au

Web: www.realoffshore.com.au



REAL
MARINE

Note: Products and technology are subject to change at anytime due to our continuous improvement programmes
Warranty does not include wear and tear items, mishandling and labor costs